



Montezuma Community Schools

Renovation of Existing School

Design Alliance, Inc.
September 24, 2012





Agenda

- **Budget:**
 - Asbestos Abatement
 - Site Survey Expansion
 - Cost Estimate Schedule
- **Drawings:**
 - Drafting Classroom Dimensions
 - New Link Exterior Design
 - Existing HVAC Unit Spaces
 - Flooring Options and Comparison
 - Reception Area Update
- **Miscellaneous:**
 - Code Analysis



Budget

- **Asbestos Abatement – Ames Environmental**
 - \$19,000 – Specs, Air Monitoring, Project Supervision
 - \$90,000 – Abatement Estimate
- **Site Survey Expansion - Bishop Engineering**
 - \$2,780 – Additional survey at south side of site
- **Cost Estimate Schedule – Stecker-Harmsen**
 - Submitted for 50% CD Estimate September 26, 2012



Drafting Classroom

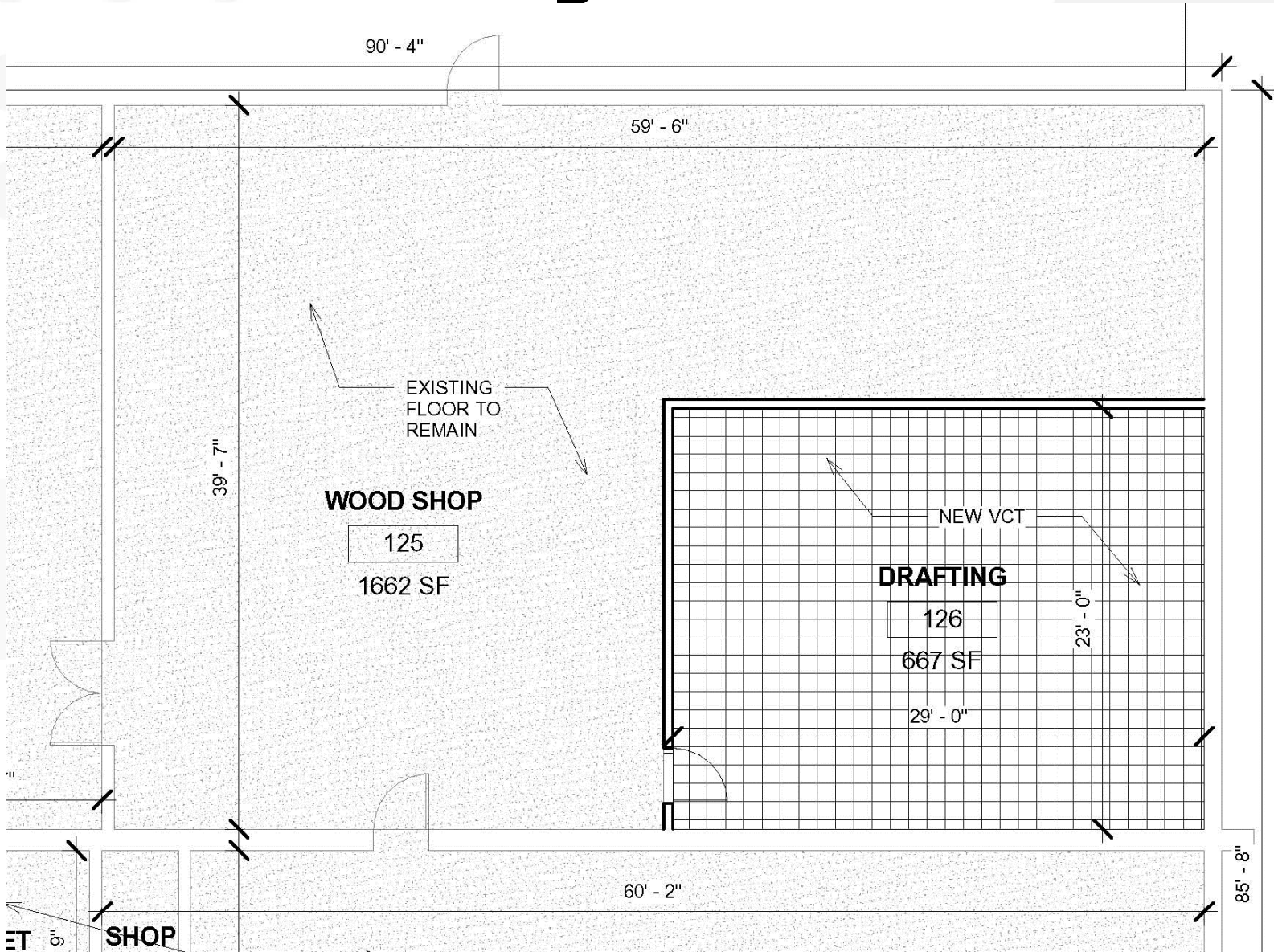

New Link

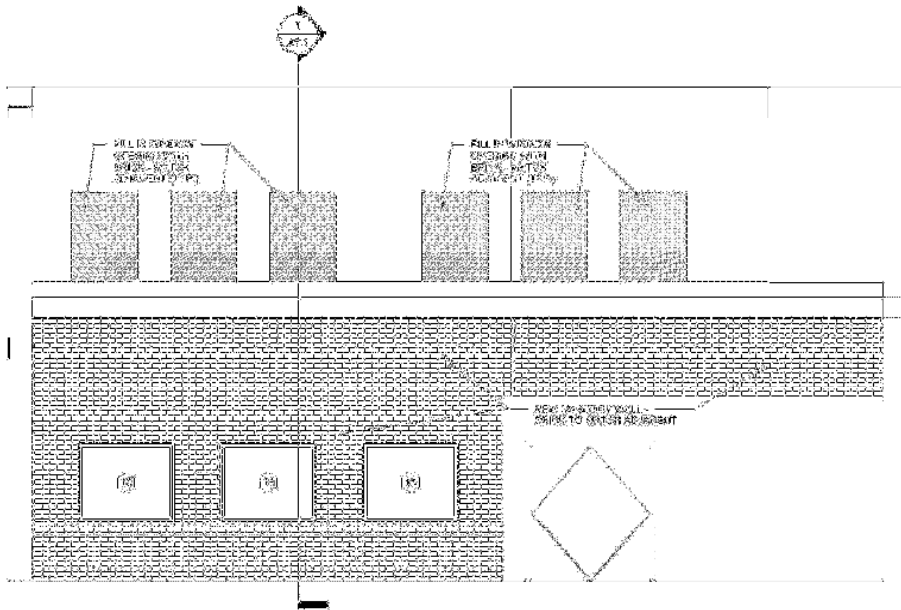

Brick finish to match existing with fixed windows.

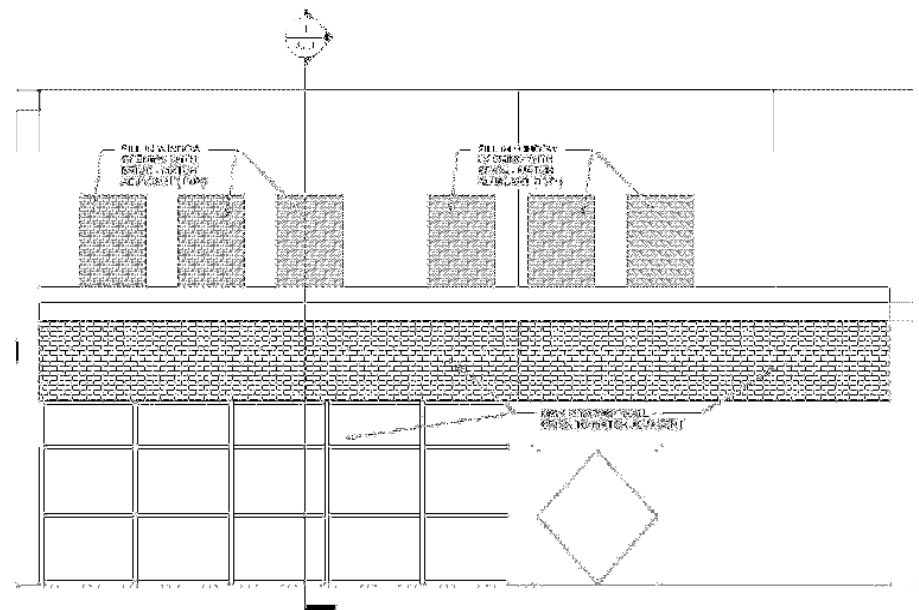

Aluminum storefront window system.



Existing HVAC Unit Spaces

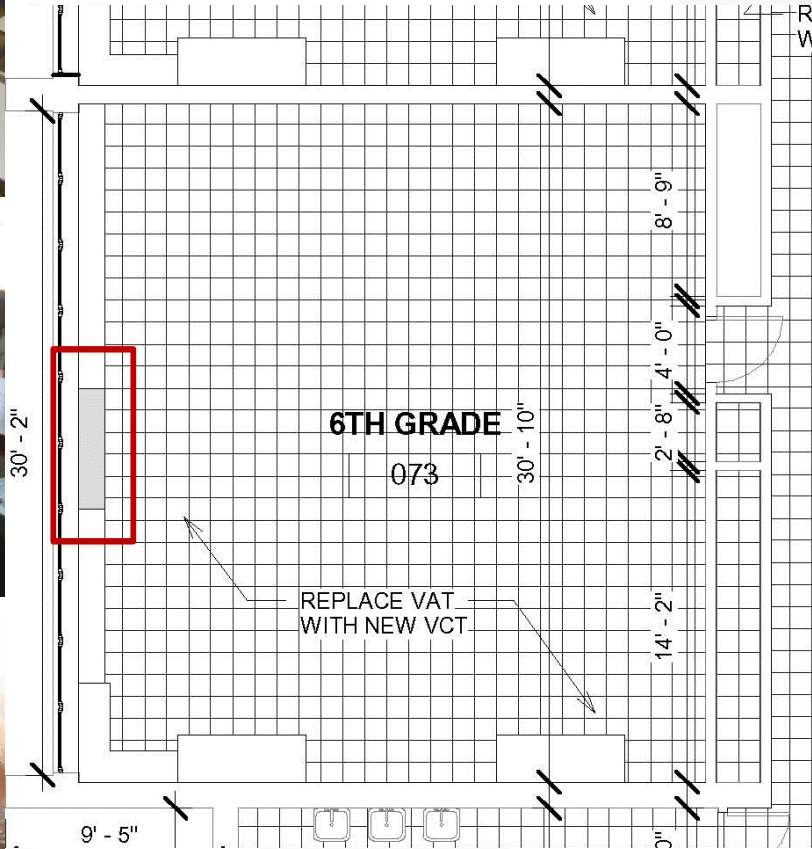



Flooring Options

	Replace Existing	Cost	All Classrooms	Cost	Corridors	Cost
Carpet \$16-21 SY	1,670 SY	\$26,720 - \$35,070	4,445 SY	\$71,120 - \$93,345	1,590 SY	\$25,440 - \$33,390
Flotex \$6-7 SF	15,000 SF	\$90,000 - \$105,000	40,000 SF	\$240,000 - \$280,000	14,300 SF	\$85,800 - \$100,100
VCT \$1.75-2.50	20,000 SF	\$35,000 - \$50,000	40,000 SF	\$70,000 - \$100,000	14,300 SF	\$25,025 - \$35,750
MCT \$2.75-3.25 SF	20,000 SF	\$55,000 - \$65,000	40,000 SF	\$110,000 - \$130,000	14,300 SF	\$39,325 - \$46,475



Structured Motion Modular





Reception Area

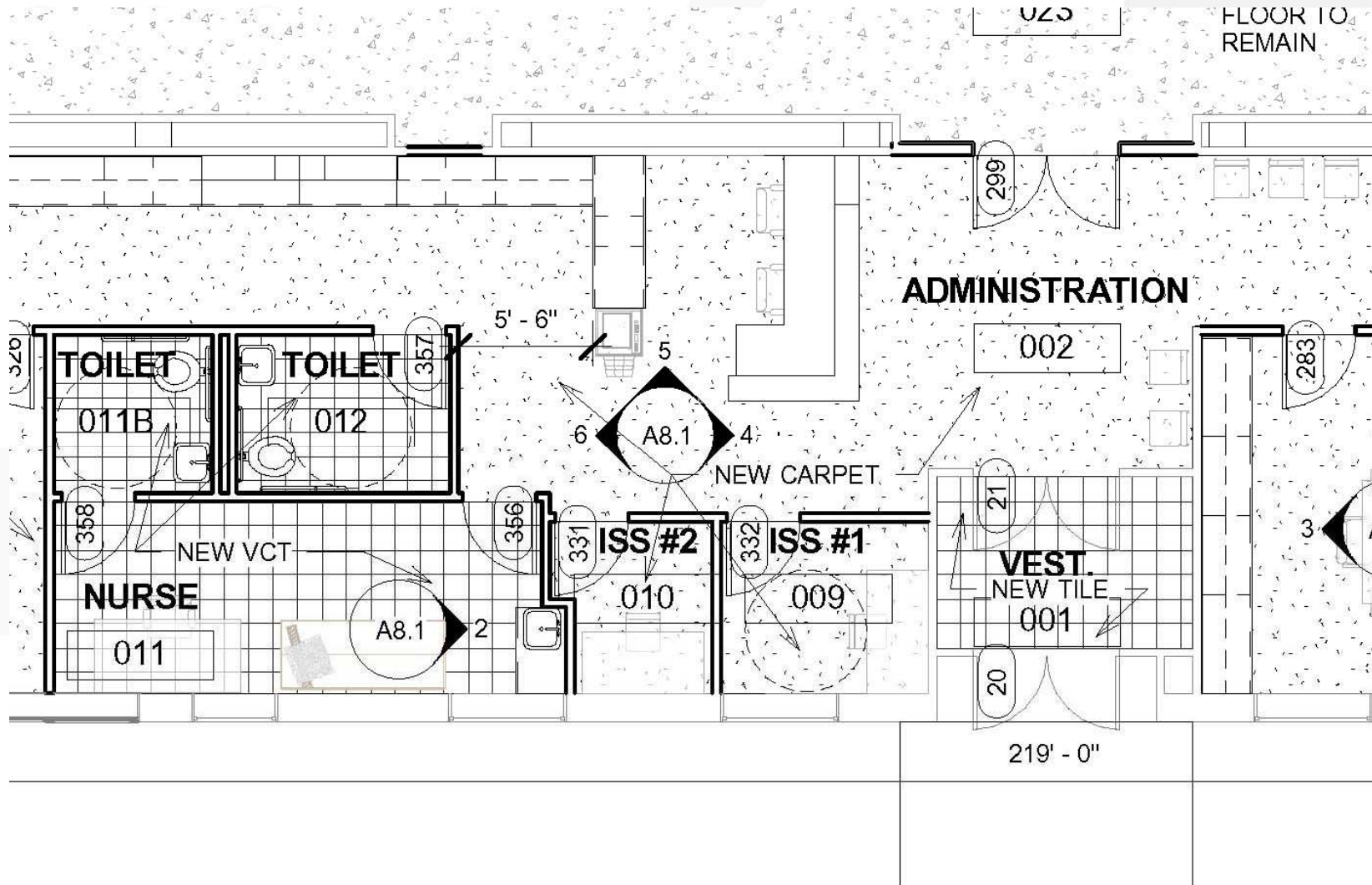



Code Analysis

- Building Type IIIA
- Separate buildings with 2hr Fire Wall
- No need for stair enclosures.
- Automatic Sprinkler System reduces need of fire wall and fire door requirements.



Design Process

- Schematic Design (15%)
- Design Development (20%)
- **Construction Documents (50%)**
- Bidding (5%)
- Construction Admin (20%)



Schedule

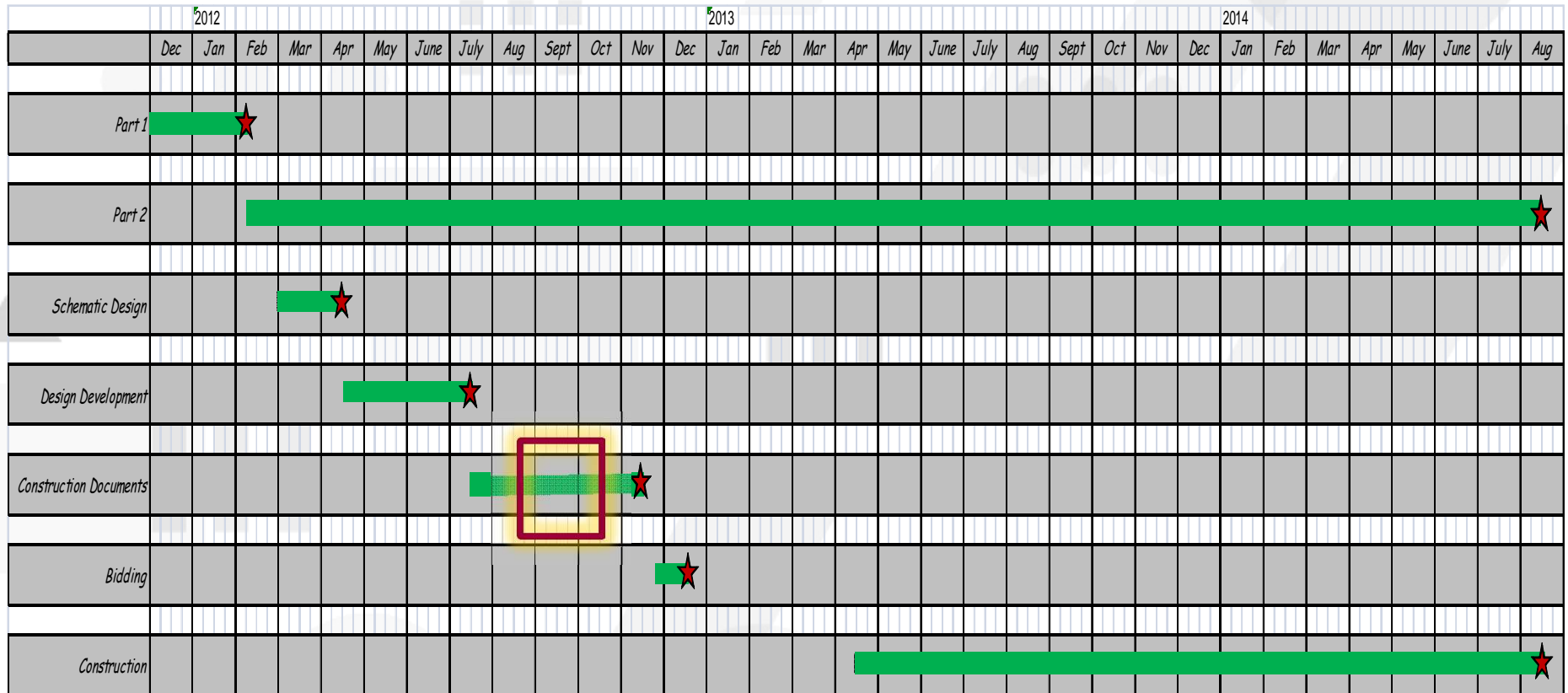

Questions and Comments

